

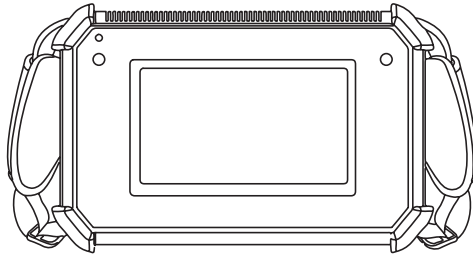

ICI

INFRARED CAMERAS INC

SOUND DETECT & SOUND DETECT PRO QUICK START GUIDE



ICI cameras fall under US Federal Law and Export Control.

2105 W. Cardinal Dr. Beaumont, TX 77705
Phone: (409) 861-0788
Toll Free: (866) 861-0788
infraredcameras.com
support@infraredcameras.com
We Are IR™

©Copyright 2023, Infrared Cameras, Inc. - All rights reserved. The contents of this document may not be reproduced in whole or in parts without the written consent of the copyright owner.

Printed in the United States of America.

2105 W. Cardinal Dr.
Beaumont, TX 77705
(866) 861-0788
www.infraredcameras.com

Revision: 03.2023-001

THE MANUFACTURER RESERVES THE RIGHT TO ALTER THE SPECIFICATIONS OF THE PRODUCT WITHOUT PRIOR NOTIFICATION. THE MANUFACTURER ALLOWS HIMSELF THE RIGHT TO MODIFY WITHOUT ANY PRELIMINARY OPINION THE TECHNICAL SPECIFICATIONS OF THE PRODUCT. THIS MANUAL MAY CONTAIN TECHNICAL INACCURACIES OR TYPOGRAPHICAL ERRORS.

NOTICE ALL STATEMENTS, INFORMATION, AND RECOMMENDATIONS IN THIS MANUAL ARE BELIEVED TO BE ACCURATE BUT ARE PRESENTED WITHOUT WARRANTY OF ANY KIND. NOTWITHSTANDING ANY OTHER WARRANTY HEREIN, ALL DOCUMENT FILES AND SOFTWARE ARE PROVIDED "AS IS" WITH ALL FAULTS. ICI DISCLAIMS ALL WARRANTIES, EXPRESSED OR IMPLIED, INCLUDING, WITHOUT LIMITATION, THOSE OF MERCHANTABILITY, FITNESS FOR A PARTICULAR PURPOSE AND NON-INFRINGEMENT OR ARISING FROM A COURSE OF DEALING, USAGE, OR TRADE PRACTICE.

THE SOFTWARE LICENSE AND LIMITED WARRANTY FOR THE ACCOMPANYING PRODUCT ARE SET FORTH IN THE INFORMATION PACKET THAT SHIPPED WITH THE PRODUCT AND ARE INCORPORATED HEREIN BY THIS REFERENCE. IF YOU ARE UNABLE TO LOCATE THE SOFTWARE LICENSE OR LIMITED WARRANTY, CONTACT YOUR ICI REPRESENTATIVE FOR A COPY.

IN NO EVENT SHALL ICI BE LIABLE FOR ANY INDIRECT, SPECIAL, CONSEQUENTIAL, OR INCIDENTAL DAMAGES, INCLUDING, WITHOUT LIMITATION, LOST PROFITS OR LOSS OR DAMAGE TO DATA ARISING OUT OF THE USE OR INABILITY TO USE THIS MANUAL, EVEN IF ICI HAS BEEN ADVISED OF THE POSSIBILITY OF SUCH DAMAGES.

Package Includes

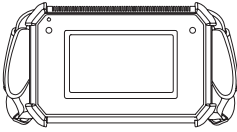

Sound Detect Device



Memory Card

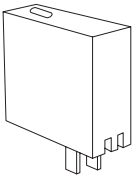

Charger

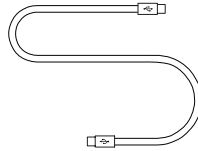

Type-C Cable

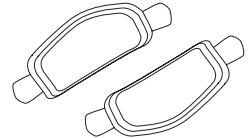

Hand Straps

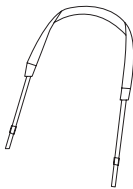

Neck Strap

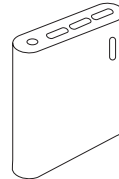

Optional: Power Bank

ENSURE ALL SYSTEM EQUIPMENT AND COMPONENT ITEMS ARE PRESENT BEFORE CONTINUING.

Set Up

A.

Mount the fully charged acoustic device to a tripod using the 1/4"-20 mount located on the bottom of the acoustic device.

The Sound Detect is used as a handheld acoustic device.

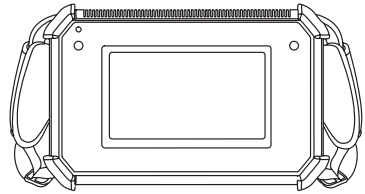
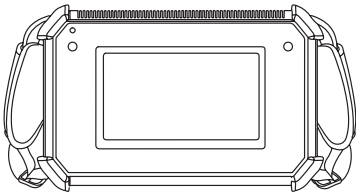

or

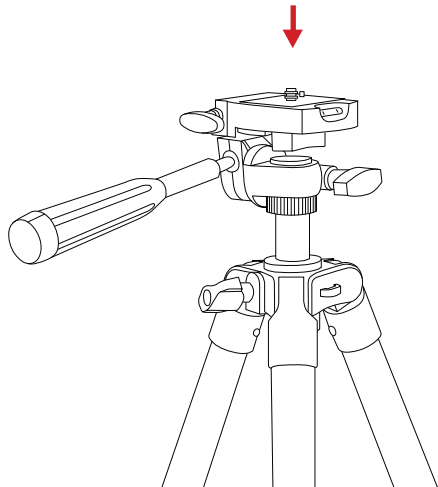
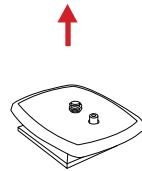

MAKE SURE TRIPODS DO NOT BLOCK THE DIRECT PATH OF PERSON(S) TO BE IMAGED TO ENSURE THE EQUIPMENT WILL NOT BE MOVED OR KNOCKED DOWN. USING A DIVIDING BARRIER WILL HELP KEEP TRIPODS SEPARATE FROM THE PATH.

TURN ON THE CAMERA BY PRESSING AND HOLDING THE POWER BUTTON FOR AT LEAST TWO SECONDS.

B.

Power on device.

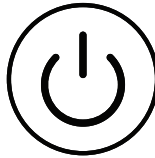

PRESS AND HOLD THE POWER BUTTON FOR MORE THAN 5 SECONDS TO SHUT DOWN THE CAMERA.

THE ACOUSTIC DEVICE NEEDS SUFFICIENT WARM-UP TIME FOR THE MOST ACCURATE MEASUREMENTS AND BEST IMAGE QUALITY. THIS TIME CAN OFTEN VARY BY ENVIRONMENTAL CONDITIONS. IT IS BEST TO WAIT A MINIMUM OF 10 MINUTES FOR THE ACOUSTIC DEVICE TO COMPLETELY WARM-UP.

Charging via Power Adapter

A.

Plug one end of the Type-C cable into the power adapter.

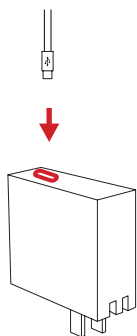

B.

Plug the other end of the Type-C cable into the acoustic device.

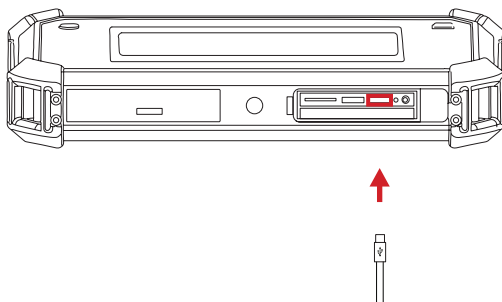

C.

Plug power adapter into a 110/120V electrical outlet.

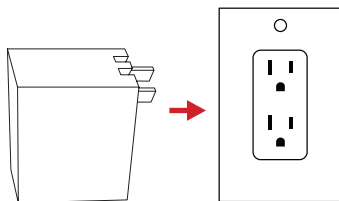

IT TAKES 4-6 HOURS TO CHARGE AN EMPTY BATTERY TO FULL.

THE STATUS LED POWERS ON WHEN THE BATTERY IS BEING CHARGED. THE STATUS LED TURNS OFF WHEN CHARGING IS COMPLETE.

THE DEVICE IS NOT MEANT TO BE USED WHILE CHARGING. KEEP THE DEVICE POWER OFF WHEN CHARGING.

ENSURE THE BATTERY IS NEAR ROOM TEMPERATURE BEFORE CHARGING. DO NOT CHARGE THE BATTERY IN EXTREMELY HOT OR COLD AREAS. THE BATTERY CAPACITY MAY BE DECREASED IF CHARGED IN AN EXTREME TEMPERATURE ENVIRONMENT.

WHEN THE BATTERY IS FULLY CHARGED, THE DEVICE DISPLAYS 4 GRIDS OF ELECTRICITY AND CAN BE USED FOR UP TO 6 HOURS; 3 GRIDS CAN BE USED FOR ABOUT 2.5 TO 3 HOURS; 2 GRIDS CAN BE USED FOR ABOUT 1.5 TO 2 HOURS; 1 GRID CAN BE USED FOR ABOUT HALF AN HOUR TO 1 HOUR.

IF YOU DO NOT USE THE ACOUSTIC DEVICE FOR A LONG PERIOD OF TIME, PUT THE DEVICE IN A COOL AND DRY ENVIRONMENT. THE BATTERY WILL DISCHARGE OVER TIME; THEREFORE, THE ACOUSTIC DEVICE SHOULD BE CHARGED OCCASIONALLY TO PREVENT DAMAGE TO THE BATTERY OR THE ACOUSTIC DEVICE.

Charging via Power Bank

A.

Plug one end of the Type-C cable into the power bank.

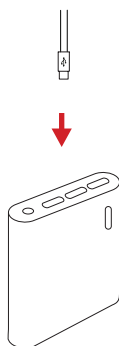

B.

Plug the other end of the Type-C cable into the device.

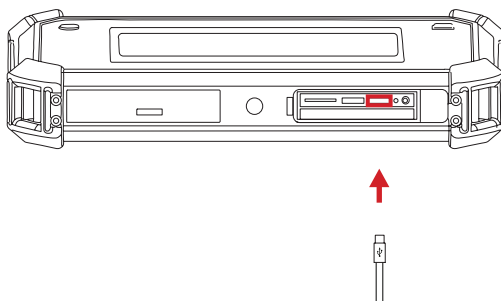

IT TAKES 4-6 HOURS TO CHARGE AN EMPTY BATTERY TO FULL.

THE STATUS LED POWERS ON WHEN THE BATTERY IS BEING CHARGED. THE STATUS LED TURNS OFF WHEN CHARGING IS COMPLETE.

THE DEVICE IS NOT MEANT TO BE USED WHILE CHARGING FROM THE POWER BANK. KEEP THE DEVICE POWER OFF WHEN CHARGING.

ENSURE THE BATTERY IS NEAR ROOM TEMPERATURE BEFORE CHARGING. DO NOT CHARGE THE BATTERY IN EXTREMELY HOT OR COLD AREAS. THE BATTERY CAPACITY MAY BE DECREASED IF CHARGED IN AN EXTREME TEMPERATURE ENVIRONMENT.

Charging the Power Bank

A.

Plug one end of the Type-C cable into the power adapter.

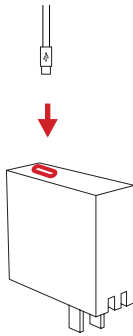

B.

Plug the other end of the Type-C cable into the power bank.

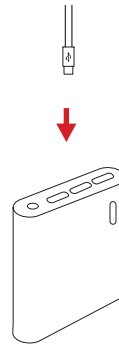

C.

Plug power adapter into a 110/120V electrical outlet.

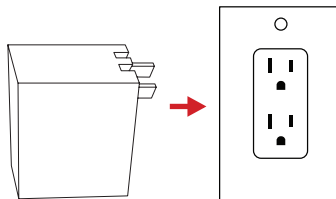

IT TAKES 4-6 HOURS TO CHARGE AN EMPTY POWER BANK TO FULL.

THE STATUS LED POWERS ON WHEN THE POWER BANK IS BEING CHARGED. THE STATUS LED TURNS OFF WHEN CHARGING IS COMPLETE.

THE POWER BANK IS NOT MEANT TO BE USED WHILE CHARGING. KEEP THE POWER BANK DISCONNECTED FROM THE ACOUSTIC DEVICE WHEN CHARGING.

ENSURE THE POWER BANK IS NEAR ROOM TEMPERATURE BEFORE CHARGING. DO NOT CHARGE THE POWER BANK IN EXTREMELY HOT OR COLD AREAS. THE POWER BANK CAPACITY MAY BE DECREASED IF CHARGED IN AN EXTREME TEMPERATURE ENVIRONMENT.

IF YOU DO NOT USE THE POWER BANK FOR A LONG PERIOD OF TIME, PUT THE POWER BANK IN A COOL AND DRY ENVIRONMENT. THE POWER BANK WILL DISCHARGE OVER TIME; THEREFORE, THE POWER BANK SHOULD BE CHARGED OCCASIONALLY TO PREVENT DAMAGE TO THE POWER BANK OR THE ACOUSTIC DEVICE.

Memory

A.

Align the USB drive and insert it into the side of the acoustic device.

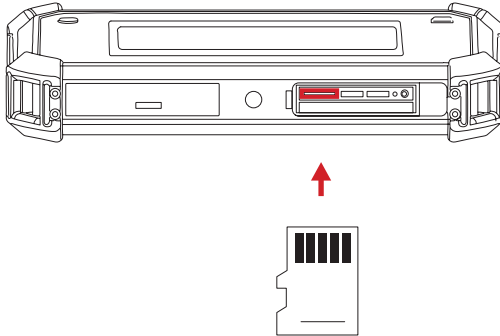

DO NOT FORCE THE MEMORY CARD INTO THE SLOT. THE SIDE OF THE CARD WITH CONTACT PINS MUST BE INSERTED FIRST. IF THERE IS RESISTANCE FLIP THE CARD AROUND AND TRY AGAIN. POWER OFF THE ACOUSTIC DEVICE BEFORE EJECTING THE MEMORY CARD FROM THE MEMORY SLOT.

DO NOT REMOVE OR INSERT THE MEMORY CARD WHEN VIDEO RECORDING.

AFTER TAKING PHOTOS AND RECORDING VIDEOS, PLEASE WAIT UNTIL THE DATA IS SAVED SUCCESSFULLY BEFORE INSERTING AND REMOVING THE MEMORY CARD.

DO NOT REMOVE OR INSERT THE MEMORY CARD WHEN BROWSING AND MARKING DATA UNDER THE PLAYBACK MENU.

WHEN READING MEMORY CARD DATA ON THE PC DO NOT CHANGE THE NAMES OF FILES AND FOLDERS IN THE MEMORY CARD. CHANGING FILE AND FOLDER NAMES MAY CAUSE TEST DATA TO BE INCORRECTLY IDENTIFIED AND DISPLAYED IN THE PLAYBACK MENU.

Attach the Neck Strap

A.

Ensure the strap feeds from the outside-in and through the tether points.

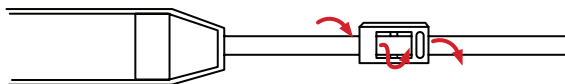

B.

Feed the end of the strap through the retainer piece and up the back of the plastic fastener on the acoustic device.

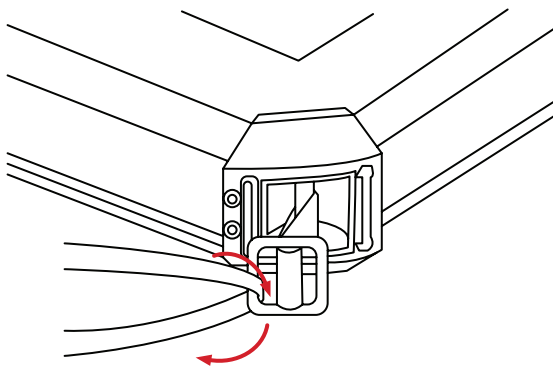

C.

Feed the strap from the inside-out and through the tether points.

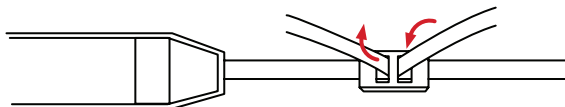

Attach the Hand Straps

A.

Feed one end of the strap from the outside-in and through the tether point.

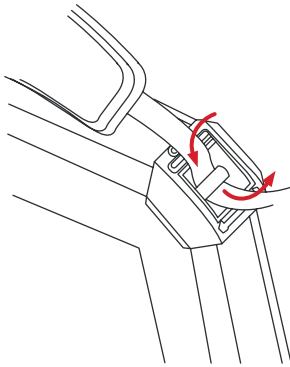

B.

Feed the other end of the strap from the outside-in and through the plastic fastener.

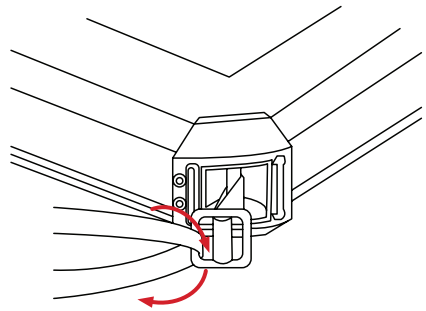

C.

Fold the straps into the strap cushion.

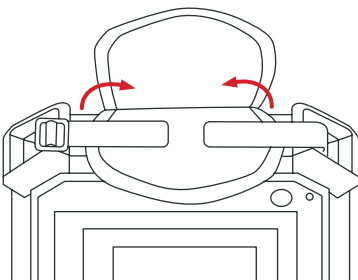

D.

Close the strap cushion.

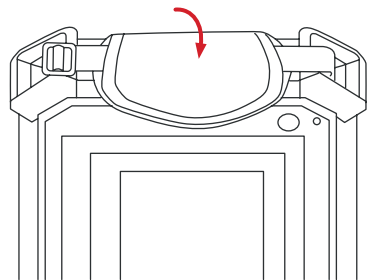

About ICI / Contact

Infrared Cameras, Inc.
2105 W. Cardinal Dr.
Beaumont, TX 77705

Phone: (409) 861-0788 | Toll Free: (866) 861-0788 | International: (409) 861-0788

General Inquiry: support@infraredcameras.com

Website: www.infraredcameras.com

You may reach a representative by phone or email Mon – Fri 8:00AM – 5:00PM CST.

ICI manufactures complete systems and software. We can provide complete engineering, software, and OEM solutions. Our Fortune 500 clients rely on us for infrared equipment and thermography training (which we offer through the Infrared Training Institute).

In addition to providing custom germanium, silica, and sapphire optics, we also build windows for enclosures, as well as custom pan and tilt units. We can even provide customizable explosion-proof systems.

Our knowledge and experience stems from years of using infrared imaging and temperature measurement instruments to provide solutions to: managers, engineers, scientists, inspectors and operators in space, power companies, medical, pulp and paper, food industry, research and development, and various process industries. You can see our products and services used in industrial, commercial, and government applications worldwide. Originally named Texas Infrared (still DBA), Infrared Cameras, Inc. has been in business since March, 1995.

Thank you for your dedicated and continued support.